

DRIVER SAFETY FEATURE GUIDE

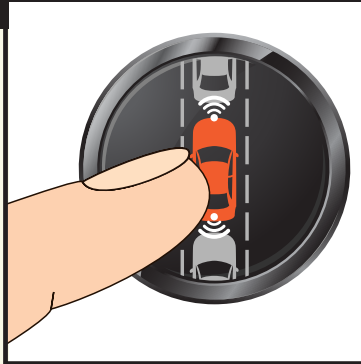

ACTIVE DRIVING ASSISTANCE



ACTIVATE. PRESS THE BUTTON(S) TO ACTIVATE. THIS MAY BE ON YOUR STEERING WHEEL OR ON A SCREEN



HOLD ON. KEEP YOUR HANDS ON THE STEERING WHEEL



STAY ALERT. WATCH THE ROAD AND YOUR INSTRUMENT PANEL FOR INDICATORS THE SYSTEM NEEDS TO DISENGAGE